



**SAFE FOR LIFE**  
Everyone. Everywhere. Everyday.



COMMUNITY NOTICE | MARCH 2025

## Bayview Heights to White Rock Underground Cable Project

Dear resident,

We are writing to provide you with an update on the essential works being delivered along Powerlink's existing 275kV underground transmission cables that run between the Bayview Heights and White Rock transition stations in Cairns.



### PROJECT OVERVIEW

The 2.7km underground cables are critical to maintaining a reliable and secure power supply for residents and businesses in the Cairns and the Far North Queensland region. Essential works are being delivered along sections of the underground cables and easement located in Mount Sheridan's Forest Gardens Estate and include:

- vegetation management along the easement, including selected removal of approximately 385 trees identified as being a high or future risk to the underground cables
- easement restoration, including replanting with compatible vegetation
- refurbishment works at two cable joint bay sites located near Alpinia Terrace and Amazon Close.

**We thank you for your continued patience as we deliver these important works.**



### CROWLEY CREEK WALKING PATH REALIGNMENT

In a recent project newsletter (March 2025), we advised residents and the local community about changes to the Crowley Creek walking path.

Essential maintenance works are required at the two underground cable joint bay sites located in the Forest Gardens Estate, and these sites are currently covered by sections of this walking path.

In consultation with Cairns Regional Council, a decision has been made to permanently realign two short sections of this walking path near the joint bay sites, as shown in the **attached** plans.

We recognise this walking path is a valued and well-used community asset enjoyed by residents and the wider community.

By realigning these sections, we can safely deliver maintenance works at the joint bay sites without impacting walking path users.

Vegetation within these areas is already marked for removal due to posing a risk to our cable. Some additional clearing may be required for these realignment works, and new shade trees will be planted, where possible, near the new sections.

As the realignment brings the walking path closer to the creek bank, new bollards or handrails will be installed to maintain safety.

We are also working with Cairns Regional Council to identify opportunities to upgrade the existing railing on the pedestrian bridge near Alpinia Terrace and will keep residents and the community updated on outcomes.

### ***What the works involve***

The works required to realign the two sections of the walking path will include:

- concreting the new, realigned sections
- installing temporary fencing around the new sections
- saw cutting and removing sections of the existing walking path
- installing new handrails and bollards as required
- turfing the area when the refurbishment works at the nearby joint bay sites are completed.



### **TIMING OF REALIGNMENT WORKS**

The walking path realignment works will start at the section near Alpinia Terrace and will then move onto the section near Amazon Close.

#### ***Section near Alpinia Terrace***

- Works are scheduled to commence from **Monday 31 March 2025** and will be completed by **mid April 2025**, weather dependent.

#### ***Section near Amazon Close***

- Works are scheduled to commence from **Monday 14 April 2025** and will be completed by **mid May 2025**, weather dependent.



### **FURTHER INFORMATION**

More information on the project is available on our website at [powerlink.com.au/bayviewheightswhiterock](https://powerlink.com.au/bayviewheightswhiterock) or by scanning this QR code.

You can also connect with our project team on 07 4034 7600 or [fnqprojects@powerlink.com.au](mailto:fnqprojects@powerlink.com.au).

#### **About Powerlink Queensland**

*Powerlink Queensland is a Government Owned Corporation that owns, develops, operates and maintains the transmission network in Queensland. We connect Queenslanders to a world-class energy future, providing electricity to more than five million Queenslanders and 241,000 businesses.*

*We are also responsible for connecting large-scale renewable energy developments, including wind and solar, and providing electricity to large industrial customers in the rail, mining and LNG sectors. Find out more about Powerlink, visit [powerlink.com.au](https://powerlink.com.au) or scan the QR code.*





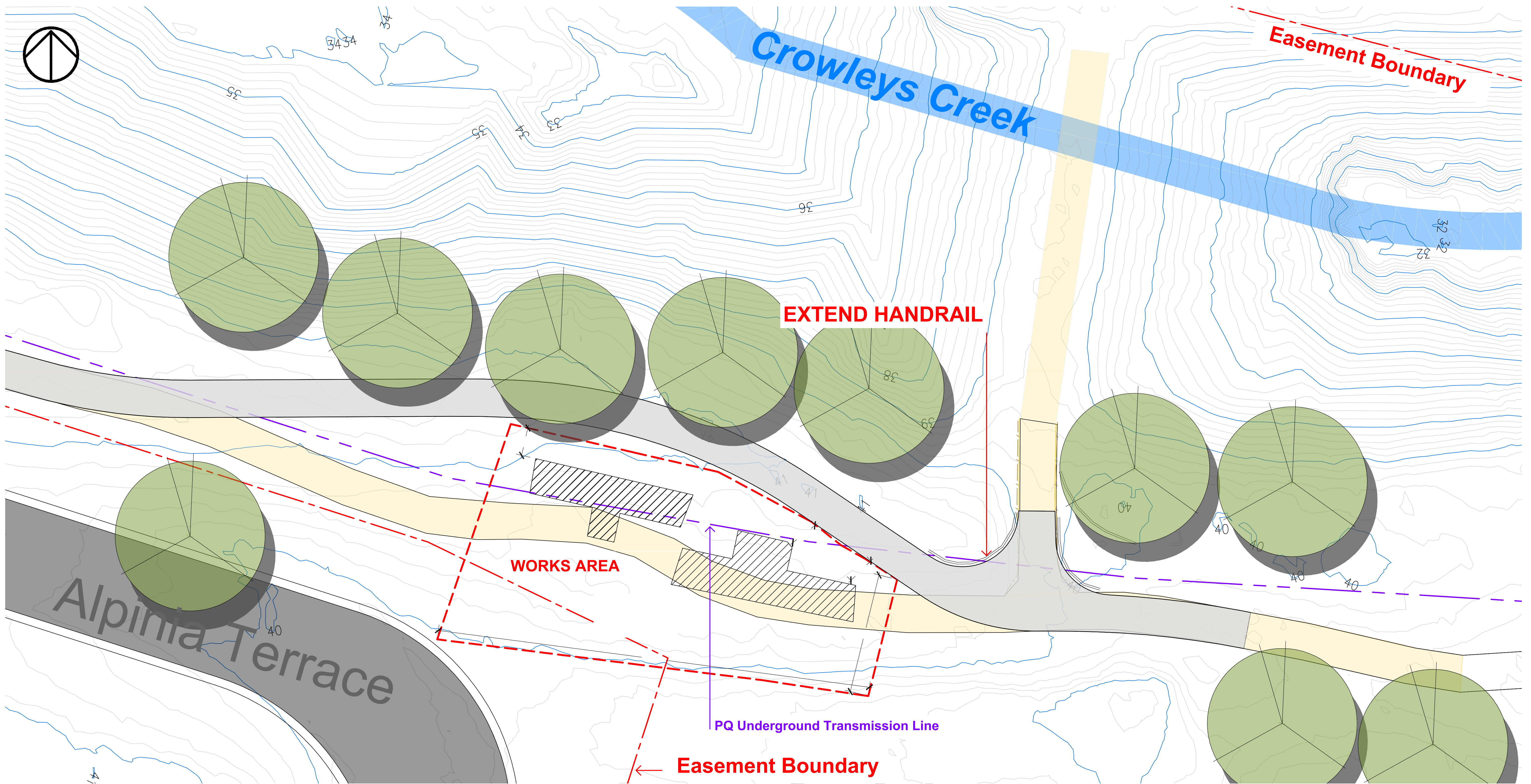

**LEGEND**

PQ UG TRANSMISSION LINE  
(CENTRE ALIGNMENT)

EASEMENT BOUNDARY

WORKS AREA

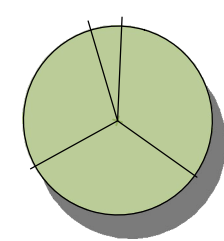

PROPOSED SHADE AMENITY  
TREE ADJACENT TO PATH

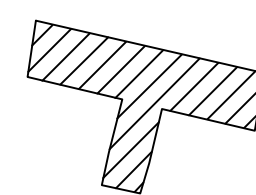

JOINT BAY

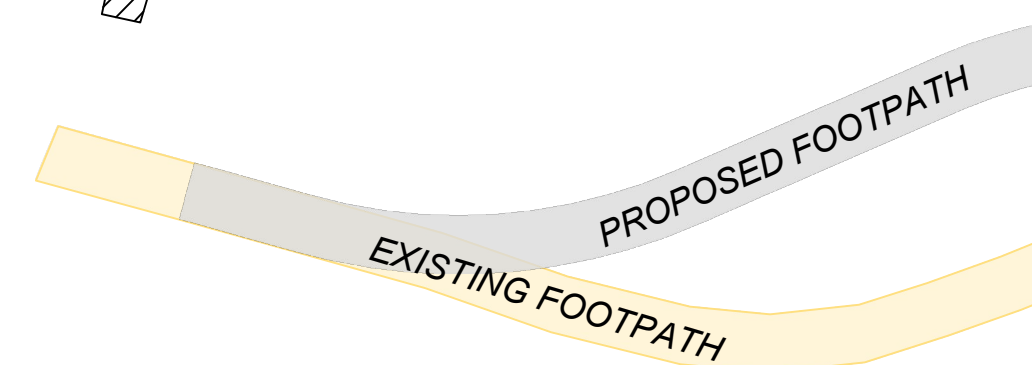

PROPOSED FOOTPATH  
EXISTING FOOTPATH



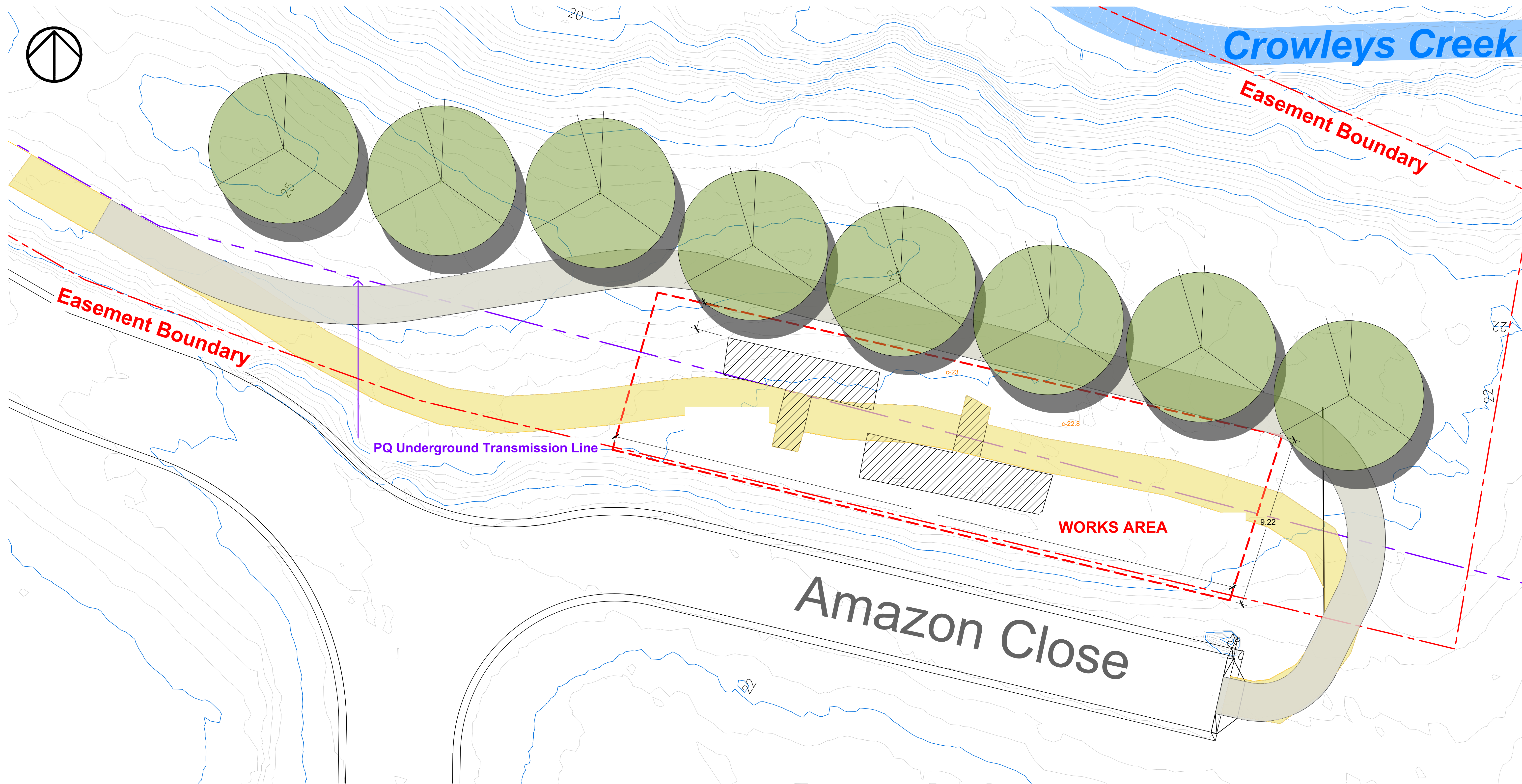
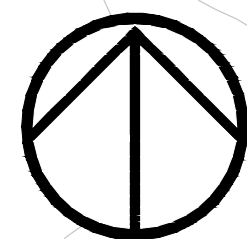

#### LEGEND

PQ UG TRANSMISSION LINE  
(CENTRE ALIGNMENT)

EASEMENT BOUNDARY

WORKS AREA

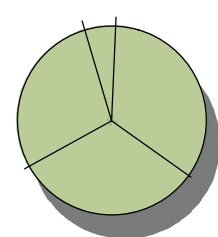

PROPOSED SHADE AMENITY  
TREE ADJACENT TO PATH

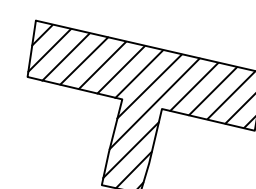

JOINT BAY

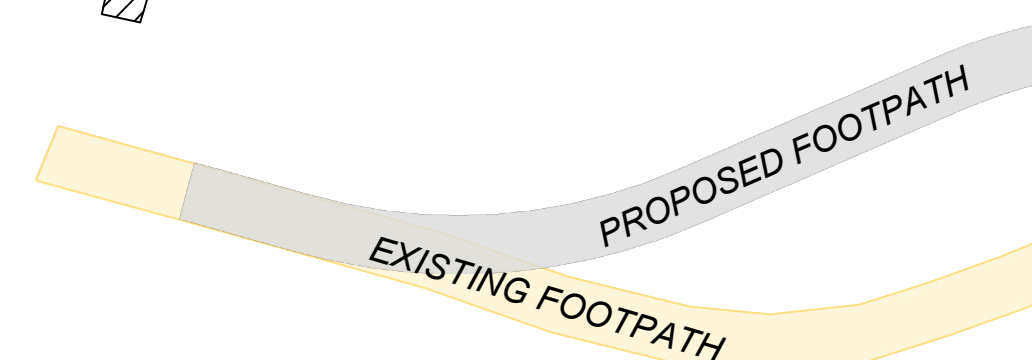

PROPOSED FOOTPATH  
EXISTING FOOTPATH

